

Whilst every attempt has been made to ensure the accuracy of the floor plan contained here, all measurements and features are approximate and no responsibility is taken for any error, omission, or mis-statement. This floor plan is for illustrative purposes only and should not be relied upon.

The information contained herein is furnished by the owner to the best of his/her knowledge, but is subject to verification by the purchaser, and agent assumes no responsibility for the correctness thereof. The sale offering is made subject to errors, omissions, change of price, prior sale, or withdrawal without notice. In accordance with the Law, this property is offered without respect to race, color, creed, national origin, sex, familial status or disability. This is not intended to solicit property currently listed. All information to be verified by Purchaser prior to closing.

Copyright© 2023-Present - Raymond Leon & Associates, LLC -
Dallas, Texas. All Rights Reserved.

**8710 BROKEN POINT DR
IRVING, TEXAS 75063**

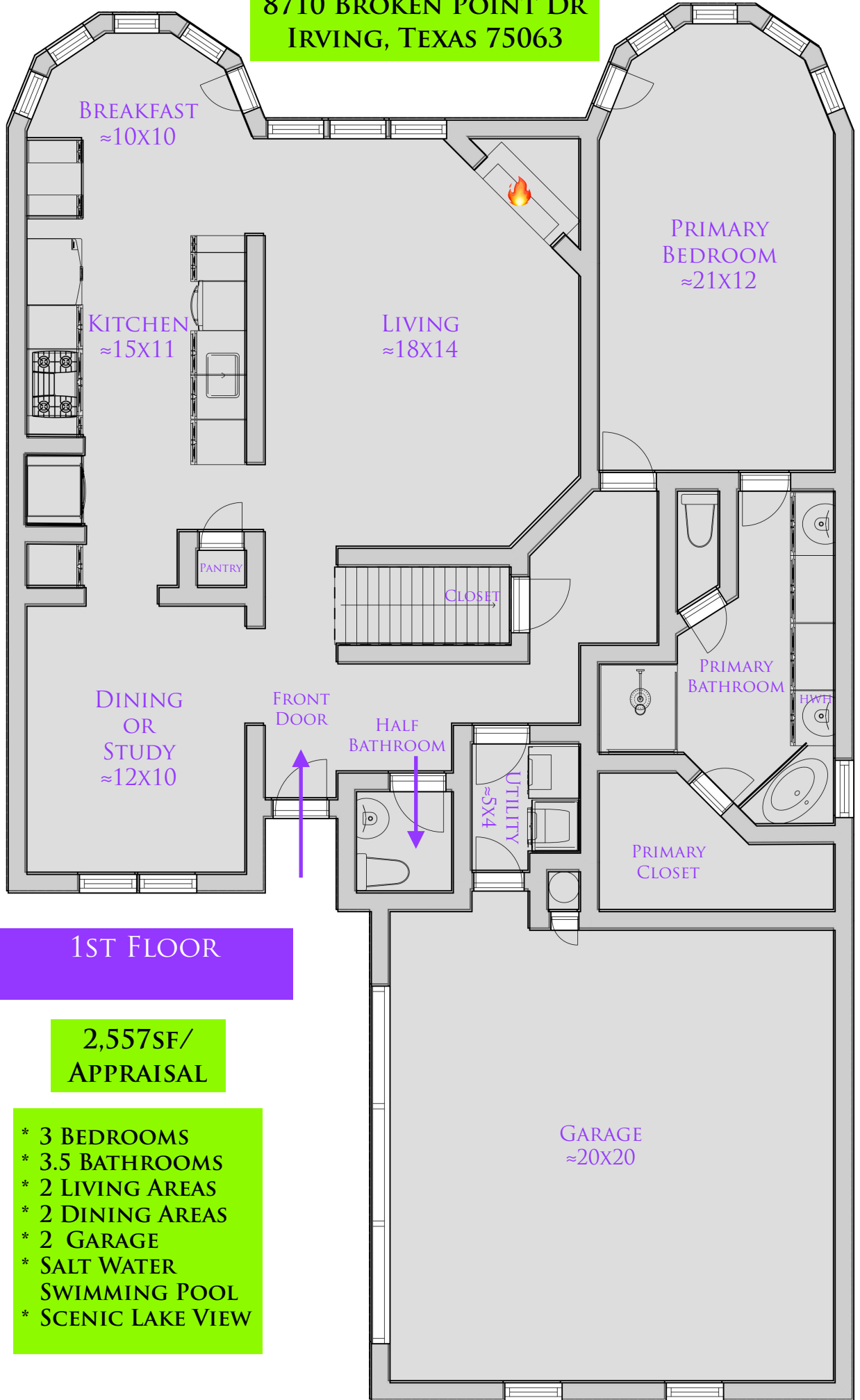

1ST FLOOR

**2,557SF/
APPRAISAL**

- * 3 BEDROOMS
- * 3.5 BATHROOMS
- * 2 LIVING AREAS
- * 2 DINING AREAS
- * 2 GARAGE
- * SALT WATER SWIMMING POOL
- * SCENIC LAKE VIEW

**GARAGE
≈20X20**