

# Building Sketch

Borrower	[REDACTED]				
Property Address	428 Sheffield Dr				
City	Richardson	County	Dallas	State	TX
Zip Code	75081				
Lender/Client	[REDACTED]				

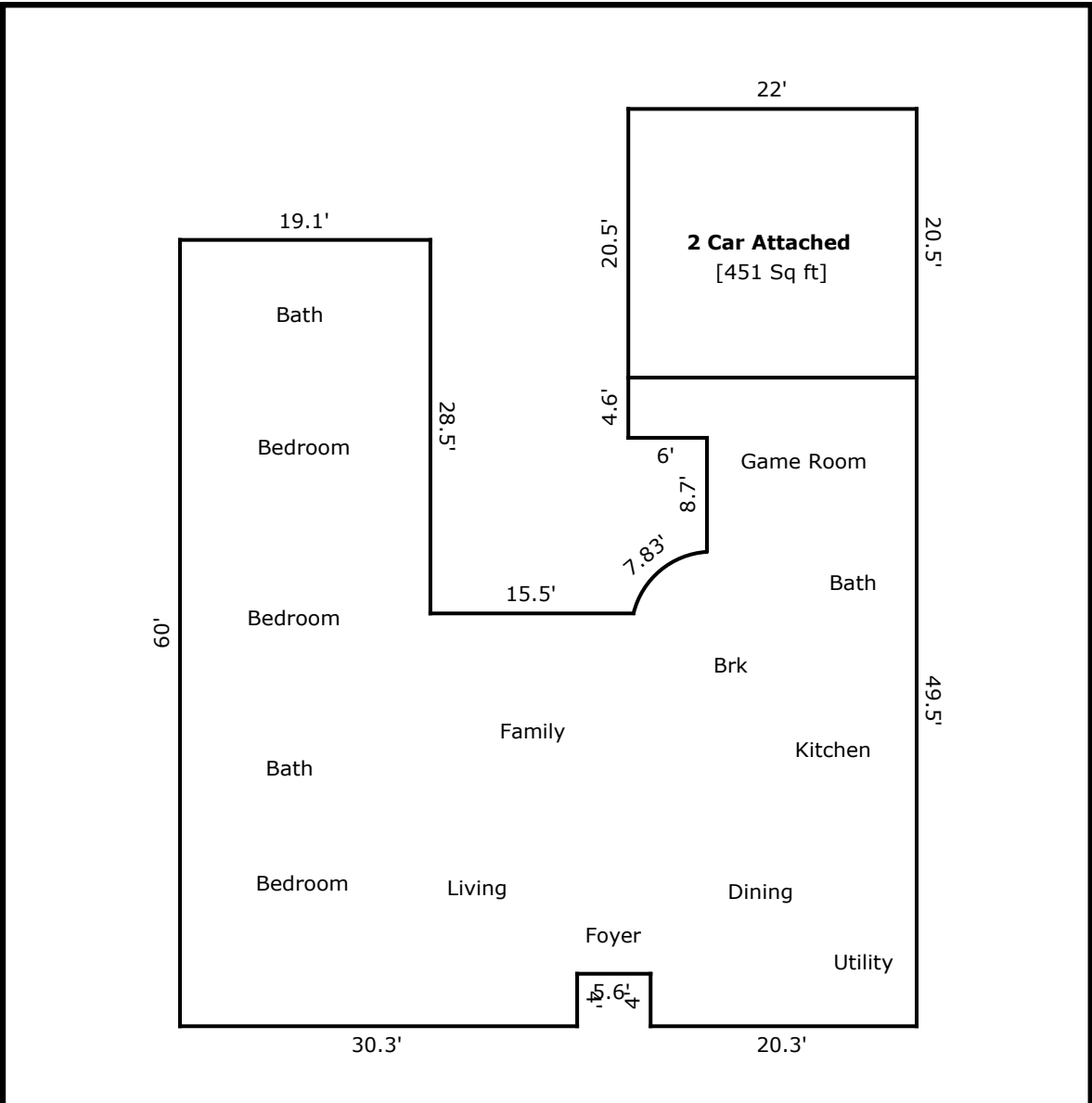

TOTAL Sketch by a la mode, inc.

### Area Calculations Summary

Living Area	Area	Calculation Details
First Floor	2626.98 Sq ft	$19.1 \times 28.5 = 544.35$ $31.5 \times 30.3 = 954.45$ $49.5 \times 16 = 792$ $4.6 \times 6 = 27.6$ $4.3 \times 4 = 17.2$ $9.9 \times 27.5 = 272.25$ $0.5 \times 5.6 \times 4.7 = 13.16$ Arc = 5.97
<b>Total Living Area (Rounded):</b>	<b>2627 Sq ft</b>	
<b>Non-living Area</b>		
2 Car Attached	451 Sq ft	$22 \times 20.5 = 451$