

Building Sketch

Borrower							
Property Address	4126 Boca Bay Dr						
City	Dallas	County	Dallas	State	TX	Zip Code	75244
Lender/Client							

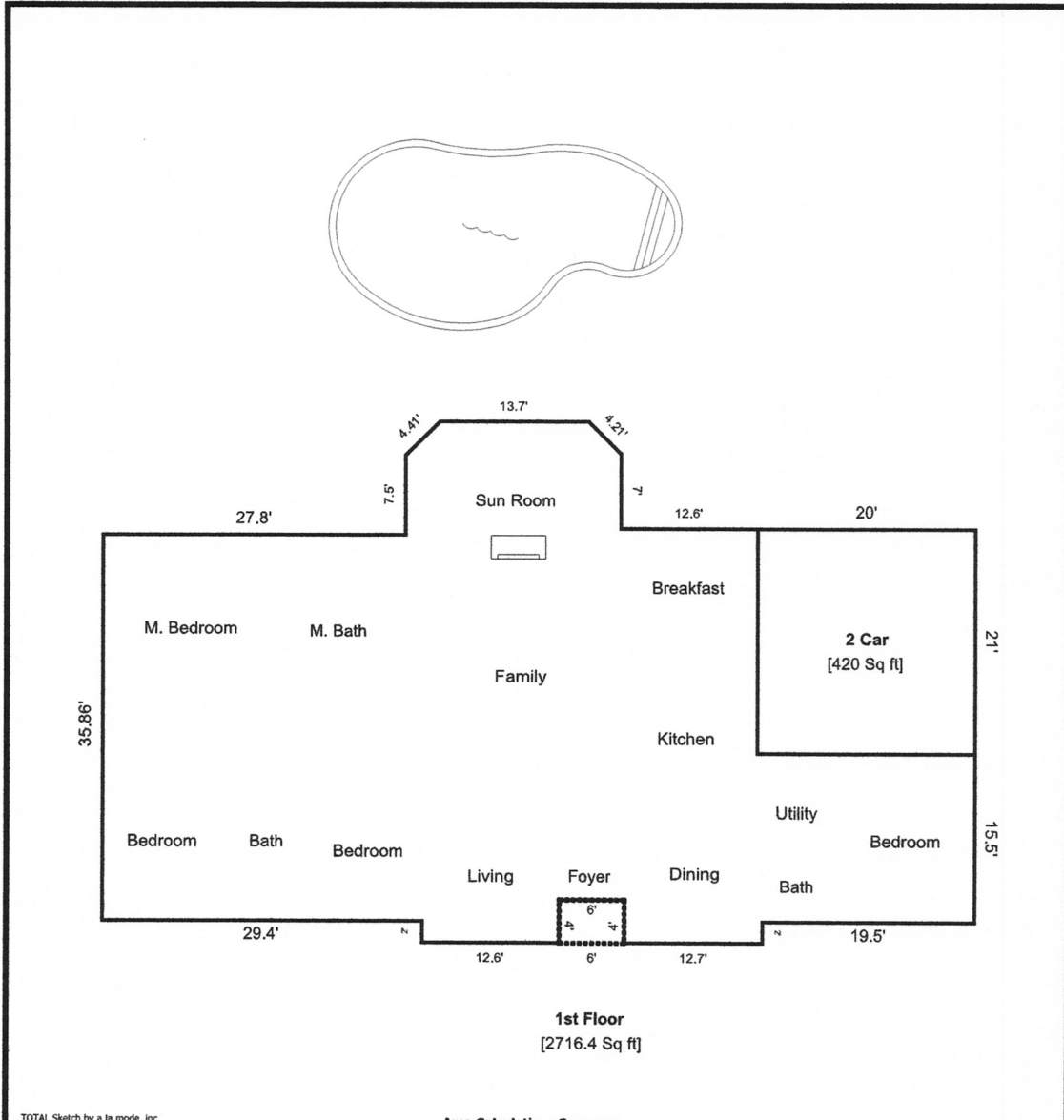

TOTAL Sketch by a la mode, inc.

Area Calculations Summary

Living Area	Area	Calculation Details
1st Floor	2716.4 Sq ft	$15.5 \times 19.5 = 302.25$ $35.86 \times 27.8 = 996.91$ $12.6 \times 2 = 25.2$ $12.7 \times 4 = 50.8$ $14.2 \times 2 = 28.4$ $32.9 \times 13.5 = 444.15$ $32.4 \times 21 = 680.4$ $19.8 \times 6.86 = 135.83$ $0.14 \times 2.98 = 0.42$ $0.5 \times 2.98 \times 2.98 = 4.44$ $3.12 \times 13.7 = 42.74$ $0.5 \times 3.12 \times 3.12 = 4.87$
Total Living Area (Rounded):	2716 Sq ft	
Non-living Area		
2 Car	420 Sq ft	$21 \times 20 = 420$