

Building Sketch (Page - 1)

Borrower	Bryan & Laura Kenney			
Property Address	1612 Silvery Canoe Way			
City	St Paul	County	Collin	State TX Zip Code 75098
Lender/Client	[REDACTED]			

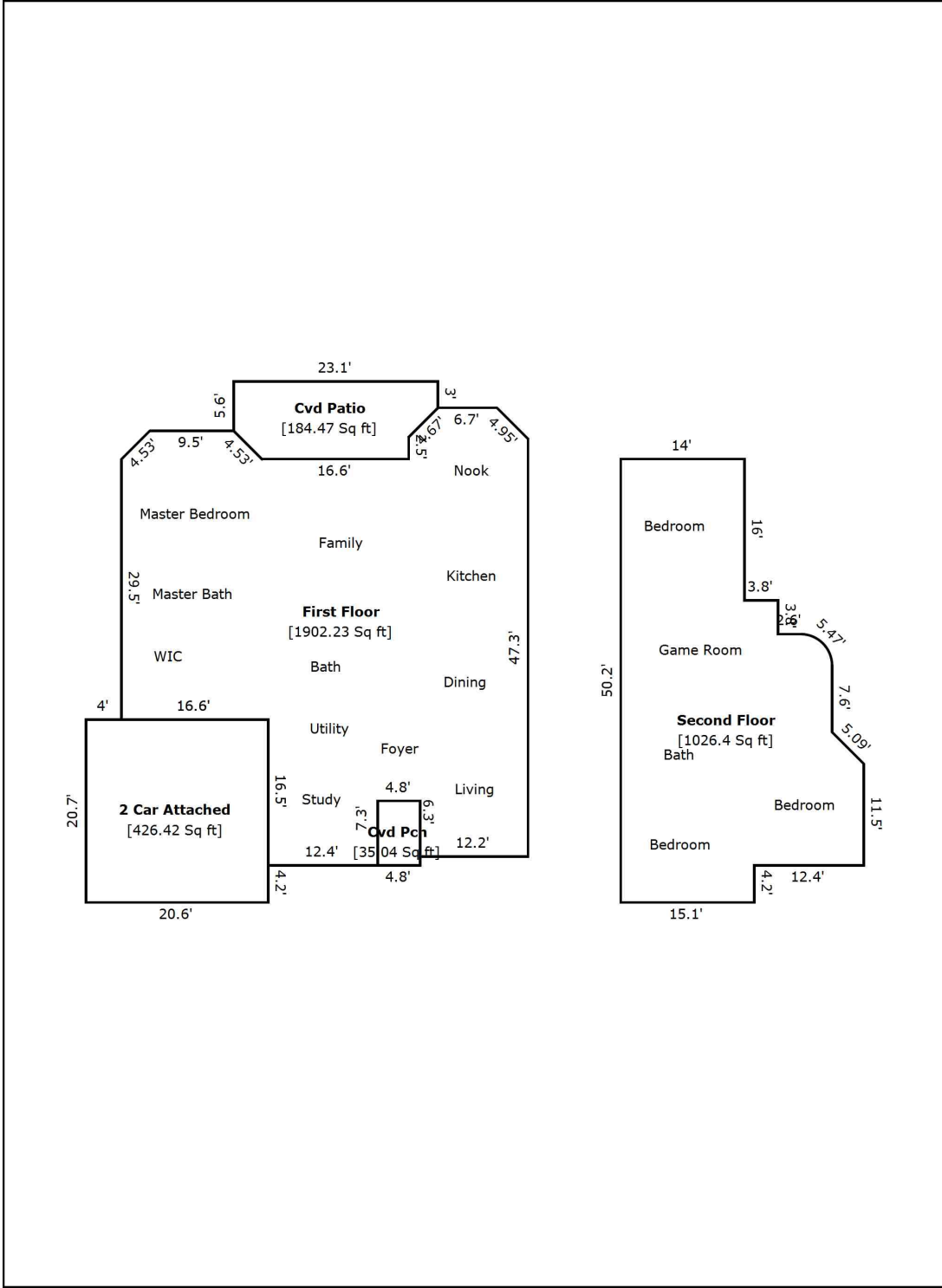

Building Sketch (Page - 2)

Borrower	Bryan & Laura Kenney		
Property Address	1612 Silvery Canoe Way		
City	St Paul	County	Collin
		State	TX
		Zip Code	75098
Lender/Client	[REDACTED]		

Living Area	Calculation Details
First Floor	1902.23 Sq ft
	$0.5 \times 3.2 \times 3.2 = 5.12$ $0.5 \times 3.2 \times 3.2 = 5.12$ $9.5 \times 3.2 = 30.4$ $12.4 \times 7.3 = 90.52$ $29.5 \times 16.6 = 489.7$ $38.7 \times 15.9 = 615.33$ $12.2 \times 6.3 = 76.86$ $13.5 \times 41 = 553.5$ $0.2 \times 3.3 = 0.66$ $0.5 \times 3.3 \times 3.3 = 5.44$ $3.5 \times 6.7 = 23.45$ $0.5 \times 3.5 \times 3.5 = 6.12$
Second Floor	1026.4 Sq ft
	$50.2 \times 14 = 702.8$ $34.2 \times 1.1 = 37.62$ $30 \times 2.7 = 81$ $26.2 \times 2.6 = 68.12$ $0.5 \times 3.5 \times 3.5 = 6.12$ $22.7 \times 3.5 = 79.45$ $0.5 \times 3.6 \times 3.6 = 6.48$ $11.5 \times 3.6 = 41.4$ Arc = 3.41
Total Living Area (Rounded):	2929 Sq ft
Non-living Area	
Cvd Patio	184.46 Sq ft
	$23.1 \times 3 = 69.3$ $2.6 \times 3.2 = 8.32$ $0.5 \times 3.2 \times 3.2 = 5.12$ $5.8 \times 16.6 = 96.28$ $0.5 \times 3.3 \times 3.3 = 5.44$
Cvd Pch	35.04 Sq ft
	$4.8 \times 7.3 = 35.04$
2 Car Attached	426.42 Sq ft
	$20.7 \times 20.6 = 426.42$