

## Building Sketch

Borrower	Torrey Johnson				
Property Address	515 Woodbine Ave				
City	Dallas	County	Dallas	State	TX
Zip Code	75203				
Lender/Client	[REDACTED]				

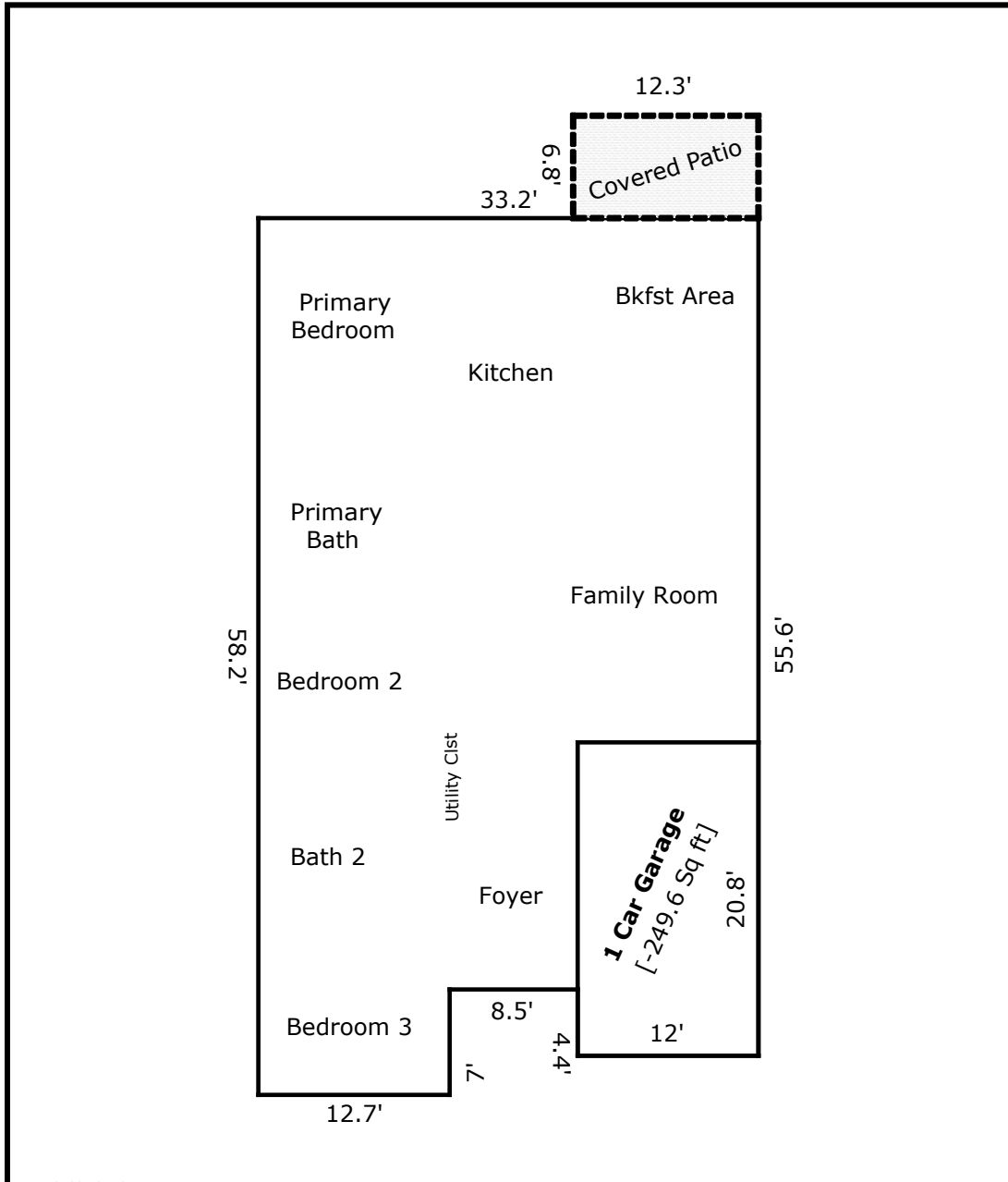

### Area Calculations Summary

Living Area	Area	Calculation Details
1 Car Garage	-249.6 Sq ft	$20.8 \times 12 = 249.6$
First Floor	1841.54 Sq ft	$33.2 \times 51.2 = 1699.84$
		$4.4 \times 12 = 52.8$
		$12.7 \times 7 = 88.9$
<b>Total Living Area (Rounded):</b>	<b>1592 Sq ft</b>	
Non-Living Area		
Cvd Patio	83.64 Sq ft	$12.3 \times 6.8 = 83.64$